

**POST MODERNE**  
**ADJUSTABLE**  
**SUSPENSION**  
**DROPPER**  
**SEATPOST**



**Model No. DP-211A**

**CONTACT US / INQUIRIES:**

**Web:** www.postmoderne.com  
**Email:** pm-info@postmoderne.com  
**Mail:**  
 Post Moderne  
 Moderne Tech Corporation  
 No.367 Kao-Shih Road  
 Yangmei, Taoyuan 326  
 Taiwan, R.O.C.

**SERVICE & REPAIR INSTRUCTIONS**

Please refer to Dimensions / Specifications / Parts / Kits listed on opposite page.

**⚠ CAUTION:**

All bicycle maintenance and installation should be installed by a qualified bicycle service technician or mechanic, in accordance with the manufacturer's installation specifications. If you are not fully qualified or experienced in the field of bicycle maintenance, then defer to a professionally trained bicycle service technician or mechanic.

**⚠ WARNING:**

Improperly installed products are at risk to fail suddenly and/or unexpectedly, causing the rider to lose control, potentially causing SERIOUS INJURY OR DEATH.

**⚠ CAUTION:**

Do not clamp your bike in a work stand by any part of the seatpost's upper tube.

**TOOLS REQUIRED:**

Allen Keys: 3mm, 5mm, 10mm  
 Post-Moderne Nut Tool  
 Torque Wrench  
 Grease (suitable for stanchions, such as Finish Line™ Teflon or Buzzy's Slick Honey™)

**DISASSEMBLY**

Follow these steps to disassemble the seatpost.

1. Raise the seatpost to full height by releasing the Remote Trigger.
2. Before removing the seatpost, make notes of: (i) seatpost height in the seat tube, (ii) saddle fore-aft position and tilt angle.
3. Remove the seatpost from the frame's seat tube.
4. If there is not enough slack in outer-housing of the remote-release cable then either un-bolt the remote-release from the handlebar or un-clamp the inner-cable from the remote-release.

5. When the seatpost clears the seat-tube then un-hook the cable nipple from the recess in the actuator assembly at the bottom of the seatpost. At this point, the seatpost should be un-tethered from the bike.
6. Use a 5mm allen key to loosen or remove the rear screw (part (B6)) of the saddle clamp assembly
7. When the set-screw underneath is accessible, then loosen it with a 3mm allenkey.
8. With a 10mm allen key, unscrew the actuator assembly (part (C6)) from the bottom of the lower-tube, along with the damper cartridge (part (A1)).

9. By hand, unscrew the Collar Ring (part (C1)) from the Lower Tube and separate the Lower Tube from the Upper Tube.
10. Separate the Lower Bushing (part (C4)), Slot Keys (2pcs of part (C3)), Upper Bushing (part (C2)) and Collar Ring.
11. At this point, the seatpost is entirely dis-assembled.
12. Clean and inspect each part and sub-assembly.
13. If any parts are worn or damaged, then order the replacement parts which are available in the Service Kits(A, B, C) listed on the opposite page.

**REASSEMBLY**

Follow these steps to re-assemble the seatpost.

15. Before sliding the Collar Ring back onto the Upper Tube, wrap the Plastic Film for Assembly (part (C5)) around the lower end of the Upper Tube. This step is important to protect the soft Wiper Seal from being damaged by the sharp machined edges that retain the Lower Bushing and Slot Keys.
16. Slide the Collar Ring over the Plastic Film and far onto the Upper Tube, past the sharp edges.
17. Slide the Upper Bushing onto the Upper Tube, past the keyways.
18. Carefully slide the Slot Keys into the keyways. Start from the bottom and slide them in longitudinally. Do not try to press them in laterally.
19. Insert the Lower Bushing by first lining it up so that it aligns with the keyways. Then when it is in position, rotate it 90° to lock into place.
20. Grease the Upper and Lower Tubes liberally between the bushings and below the wiper seal.
21. Insert the greased Lower-Tube into the Upper Tube. Make sure that the bushings and keys are in-place before inserting.
22. By hand, screw the Collar Ring tightly onto the Lower Tube.
23. Insert the tube end (fat end) of the Damper Cartridge through the bottom of the seatpost. Align the flat spot of the nub at the top with the set-screw at the top of the seatpost. Tighten the set-screw with a 3mm allen-key to 2.0 N-m.

24. By hand, thread the Actuator Assembly onto the Cartridge Lock Nut.
25. With a 10mm allen key, thread the Actuator Assembly fully into the bottom of the Lower Tube. The assembly should be bottom out, but should not be over-tightened. Torque to 50 N-m.
26. At this point, the saddle clamp assembly can be re-tightened and the saddle position re-set.
27. The nipple-end of the remote-release inner-cable should be inserted into the recess in the actuator assembly at the bottom of the post.
28. Re-install the seatpost into the frame's seat-tube.  
 > For aluminum or steel frames: Apply a thin coating of grease to the seatpost's external tube.  
 > For carbon fibre frames: Apply a thin coating of friction paste (instead of grease) to the seatpost's external tube.  
 Tighten the seatpost into the frame, using the clamping mechanism on the frame tightened to the frame manufacturer's specification.
29. Reconnect the cable and/or remote-release at the handlebar and remove any excess slack from the inner-cable.
30. Check the Remote Release. Sitting on the saddle, depress the remote release. If the saddle does not drop, then increase the cable tension by opening the barrel adjuster on the release and/or pulling more cable through the cable-clamp.

Next, unweight the saddle. If the saddle does not extend to full height, then decrease the cable tension by closing the barrel adjust on the release and/or letting out more cable through the cable-clamp.

Repeat the above steps to re-check the drop and extension.

# Specifications, Dimensions, Parts and Parts Kits

## Dropper Post Main Dimensions

Max clamp angle  
Up +14 degree  
Down -10 degree

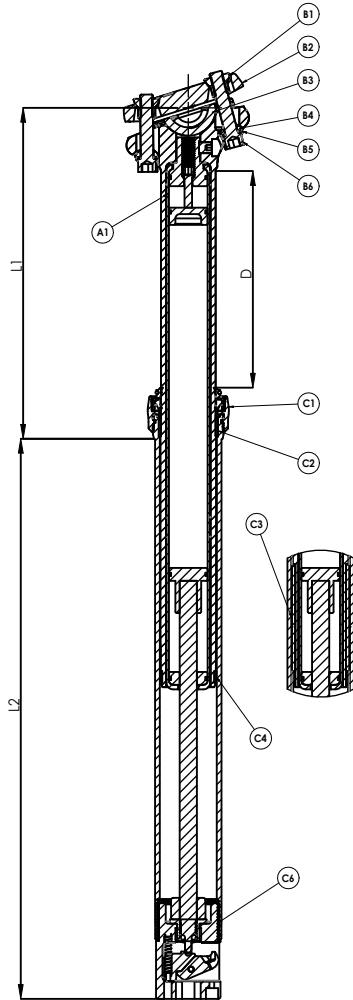

### Service Kit A:

A1. Damper cartridge assembly

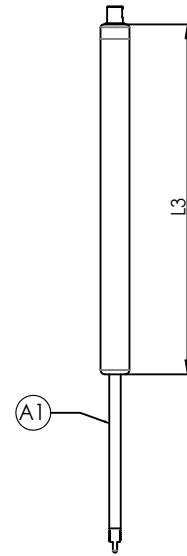

### Service Kit B:

B1. M6 nut x 2pcs  
B2. Top clamp  
B3. Bottom clamp  
B4. Ball washer x 2pcs  
B5. Spring washer x 2pcs  
B6. M6 screw x 2pcs

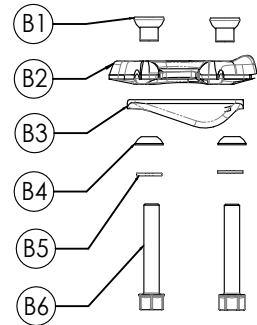

### Service Kit C:

C1. Collar ring and Seal assembly  
C2. Upper bushing  
C3. Slot key x 2pcs  
C4. Lower bushing  
C5. Plastic film for assembly step  
C6. Actuator assembly

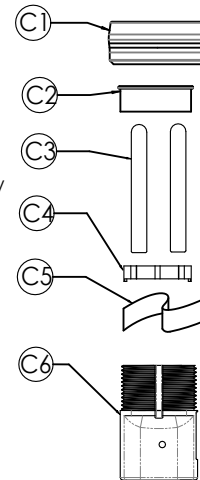

### WARNING:

ONLY USE THE COMBINATIONS OF THE SAME SPEC OF CARTRIDGE + UPPER TUBE + LOWER TUBE

Dropper Travel	Length			
	D	L1	L2	L3
75mm	78	133	180	175
100mm	103	148	215	200

Dropper Travel	Part Number		
	Service Kit A	Service Kit B	Service Kit C
75mm	237590-75SVBOM1	237590-SVBOM2	237590-SVBOM3
100mm	237590-100SVBOM1		